



FARMING EFFICIENTLY

Applying “Lean” Principles to Your Farm

WHAT IS LEAN?

- Learning to see waste
- Lean is the CONTINUOUS elimination of waste.
- “Work” is anything that adds value to the customer.
“Waste” is anything that doesn’t. The goal is zero waste and 100% work.

WHY LEAN???

- Lean increases profitability and quality while decreasing effort and defects.

It is the duty of every Christian to acquire habits of order, thoroughness, and dispatch. There is no excuse for slow bungling at work of any character. When one is always at work and the work is never done, it is because mind and heart are not put into the labor. -COL 344.1

LEARN TO SEE WASTE

- Memorize the 8 wastes:
 1. Overproduction
 2. Transportation
 3. Inventory
 4. Defects
 5. Excess motion
 6. Over processing
 7. Waiting
 8. Unused human potential

CONTINUOUS IMPROVEMENT







STRAIGHTENING THE NOODLE

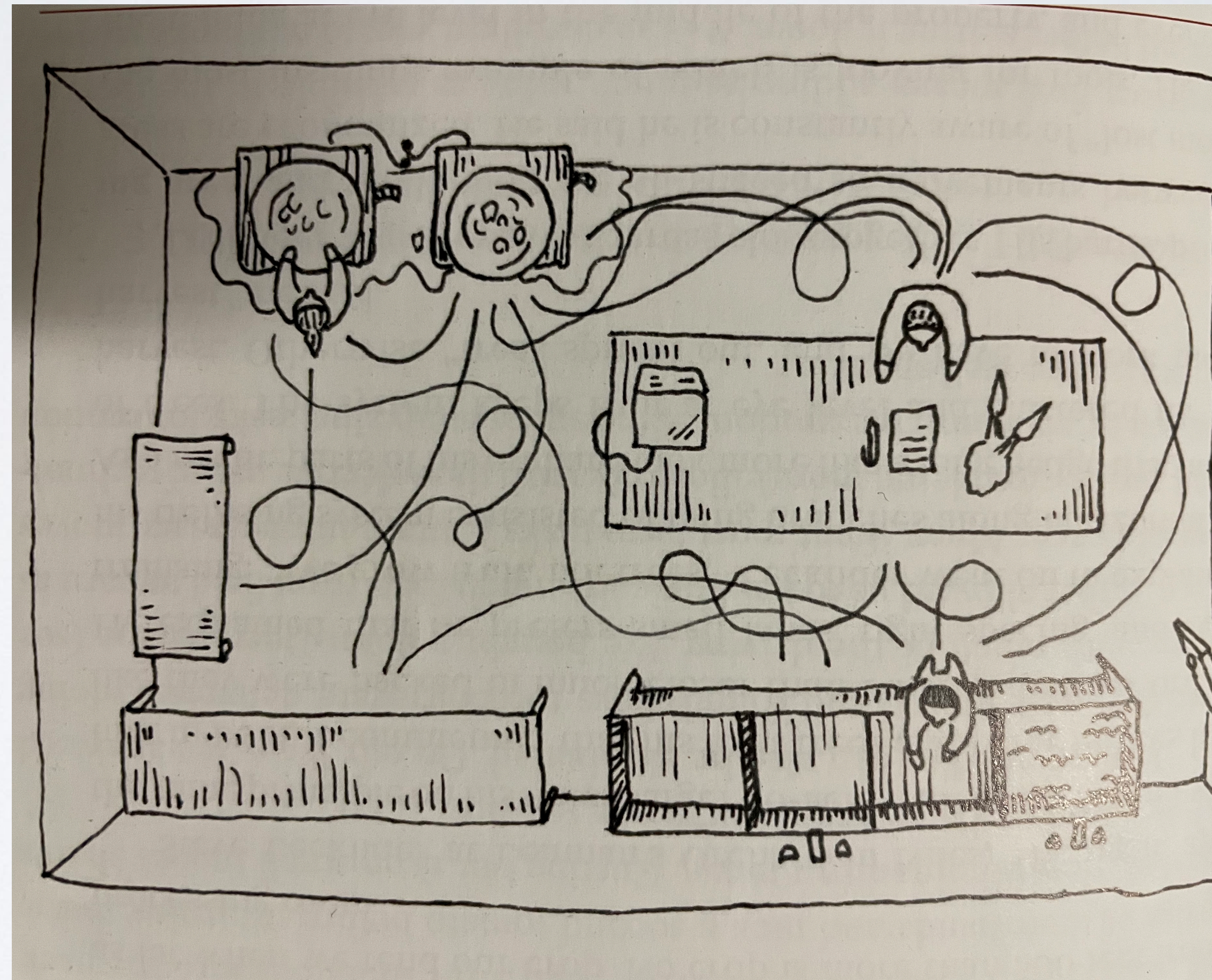

5S LEAN WORKPLACE



1. SORT

Keeping only what is necessary and discard everything else - when in doubt, throw it out.



2. SET IN ORDER

Arranging and labeling only necessary items for easy use and return by anyone.



3. SHINE

Keeping everything swept and clean for inspection for safety and preventative maintenance of equipment.



4. STANDARDIZE

The state that exists when the first three pillars or "S's" are properly maintained.



5. SUSTAIN

Making a habit of properly maintaining correct procedures.

STANDARDIZATION

- Irrigation
- Silage tarps
- Row covers
- Landscape fabric
- Fertilization rate



VISUAL CONTROLS



FIX WHAT BUGS YOU











RESOURCES

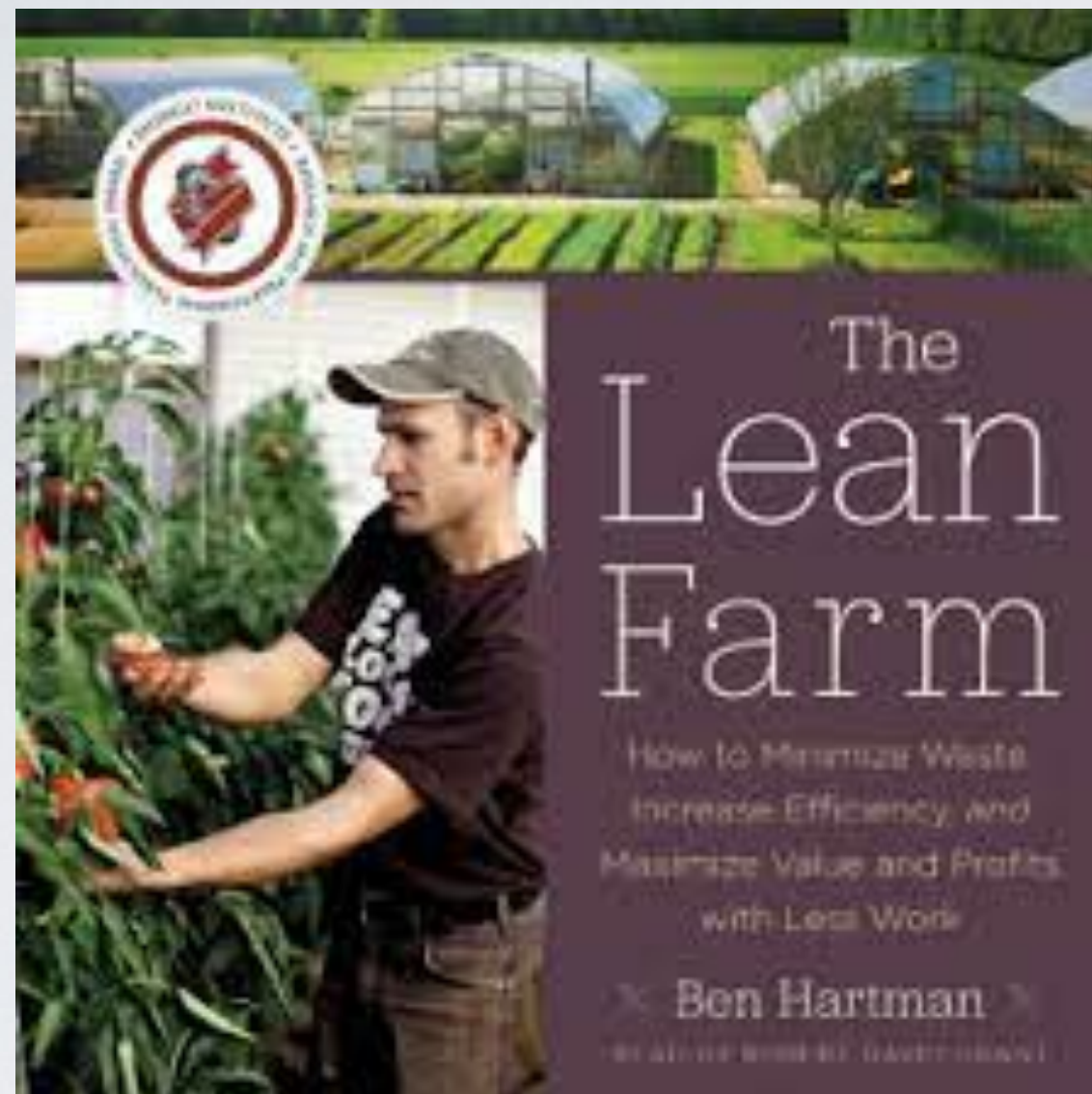

An advertisement for the LeanPlay app. On the left, three smartphones display the app's interface, including a chapter list and a video player. On the right, a red square contains the text '2 Second Lean Play'. Below this, the text 'LeanPlay' and 'Please Download the App' is displayed. At the bottom, there are two buttons: 'GET IT ON Google Play' and 'Download on the App Store'.



CONCLUSION

- Lean is SIMPLE!
- Learn to see waste
- Fix what bugs you
- Continuous improvement